

| LINE | BEARING  | DISTANCE | BEARING       |
|------|----------|----------|---------------|
| L1   | S74° 01' | 374.81   | N 01° 41' 58" |
| L2   | S73° 56' | 374.81   | N 01° 41' 58" |
| L3   | S73° 51' | 374.81   | N 01° 41' 58" |
| L4   | S73° 46' | 374.81   | N 01° 41' 58" |
| L5   | S73° 41' | 374.81   | N 01° 41' 58" |
| L6   | S73° 36' | 374.81   | N 01° 41' 58" |
| L7   | S73° 31' | 374.81   | N 01° 41' 58" |
| L8   | S73° 26' | 374.81   | N 01° 41' 58" |
| L9   | S73° 21' | 374.81   | N 01° 41' 58" |
| L10  | S73° 16' | 374.81   | N 01° 41' 58" |
| L11  | S73° 11' | 374.81   | N 01° 41' 58" |
| L12  | S73° 06' | 374.81   | N 01° 41' 58" |
| L13  | S73° 01' | 374.81   | N 01° 41' 58" |
| L14  | S72° 56' | 374.81   | N 01° 41' 58" |
| L15  | S72° 51' | 374.81   | N 01° 41' 58" |
| L16  | S72° 46' | 374.81   | N 01° 41' 58" |
| L17  | S72° 41' | 374.81   | N 01° 41' 58" |
| L18  | S72° 36' | 374.81   | N 01° 41' 58" |
| L19  | S72° 31' | 374.81   | N 01° 41' 58" |
| L20  | S72° 26' | 374.81   | N 01° 41' 58" |
| L21  | S72° 21' | 374.81   | N 01° 41' 58" |
| L22  | S72° 16' | 374.81   | N 01° 41' 58" |
| L23  | S72° 11' | 374.81   | N 01° 41' 58" |
| L24  | S72° 06' | 374.81   | N 01° 41' 58" |
| L25  | S72° 01' | 374.81   | N 01° 41' 58" |

|     |          |        |               |
|-----|----------|--------|---------------|
| L24 | S72° 06' | 374.81 | N 01° 41' 58" |
| L25 | S72° 01' | 374.81 | N 01° 41' 58" |

|     |          |        |               |
|-----|----------|--------|---------------|
| L24 | S72° 06' | 374.81 | N 01° 41' 58" |
| L25 | S72° 01' | 374.81 | N 01° 41' 58" |

| CURVE | ARC LENGTH | DELTA       | CURVE TABLE | CHORD | CHORD BEARING            |
|-------|------------|-------------|-------------|-------|--------------------------|
| C1    | 191.86     | 01° 15' 20" | 8785.00     | 95.93 | 191.05 - N 31° 56' 59" W |

- NOTES:
1. TOPOGRAPHICAL INFORMATION BASED UPON AERIAL MAPPING OF JUNE 1989.
  2. ELEVATIONS ARE BASED UPON USGS DATUM.
  3. LOTS SHOWN ON THIS PLAN ARE INTENDED FOR TITLE TRANSFER PURPOSES ONLY. NO CONSTRUCTION OR DEVELOPMENT OF THESE LOTS MAY OCCUR PRIOR TO APPROVAL OF APPLICABLE LAND DEVELOPMENT AND/OR SUBDIVISION PLANS AND APPROVAL OF OTHER REGULATORY AGENCIES.
  4. OXFORD TOWNSHIP IS CURRENTLY IN THE PROCESS OF ADOPTION OF A ZONING ORDINANCE.
  5. MINIMUM BUILDING SETBACK LINES ARE DEPENDENT UPON USE, CONTACT TOWNSHIP ZONING OFFICER FOR PERMITTED USES AND OTHER REQUIREMENTS.
  6. A HIGHWAY OCCUPANCY PERMIT IS REQUIRED, PURSUANT TO SECTION 420 OF THE ACT OF JUNE 1, 1945 (P. L. 1242 NO. 428), KNOWN AS THE STATE HIGHWAY LAW, BEFORE DRIVEWAY ACCESS TO A STATE HIGHWAY IS PERMITTED. ANY PROPERTY ACCESS TO A STATE HIGHWAY UNDER THE JURISDICTION OF THE PA. DEPARTMENT OF TRANSPORTATION MUST OBTAIN A HIGHWAY OCCUPANCY PERMIT PRIOR TO THE ISSUANCE OF A BUILDING PERMIT.
  7. THE RIGHT OF WAY LINE OF HANOVER STREET, (SR-1015), HAS BEEN ACQUIRED BY THE PA. DEPARTMENT OF TRANSPORTATION AS SHOWN ON THE PLAN.
  8. THE RIGHT OF WAY LINE OF CARLISLE PIKE, (SR-0094), HAS BEEN ACQUIRED BY THE PA. DEPARTMENT OF TRANSPORTATION FOR A WIDTH OF 25' FROM THE CENTERLINE THEREOF.
  9. TRACT NO. 20 IS CURRENTLY OWNED BY EASTERN LAND AND RESOURCES CORPORATION AND IS A SEPARATE TRACT SHOWN ONLY TO REFLECT A RECENT BOUNDARY SURVEY. THIS IS NOT A LOT CREATED BY THIS SUBDIVISION PLAN SUBMISSION.
  10. NO CONSTRUCTION SHALL TAKE PLACE IN OR NEAR THE

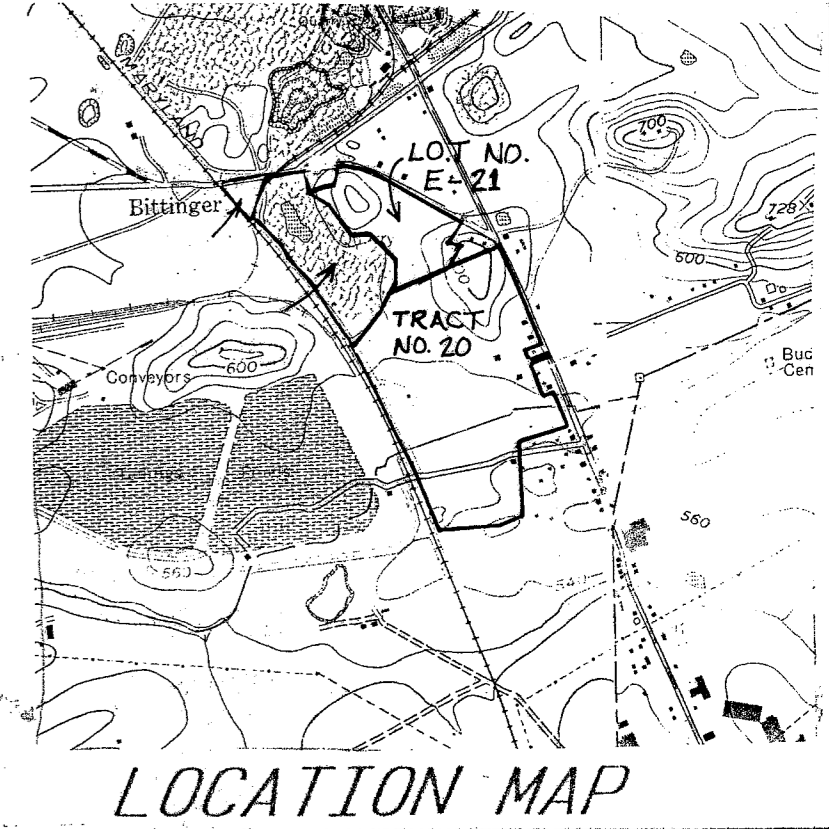
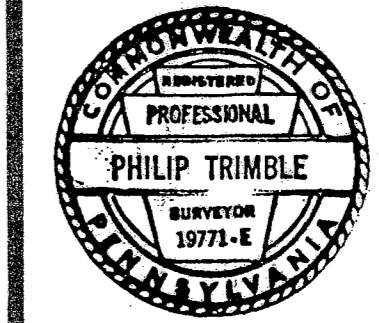
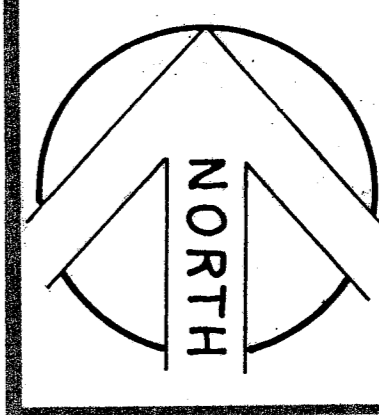

**OWNER / SUBDIVIDER**  
 BROYHILL AND ASSOCIATES, INC.  
 P.O. BOX 160  
 ANNVILLE, PA. 17003

**APPROVED:** TOWNSHIP PLANNING COMMISSION  
 DATE \_\_\_\_\_

**APPROVED:** TOWNSHIP SUPERVISORS  
 DATE \_\_\_\_\_

**SURVEYOR'S CERTIFICATE**  
 I HEREBY CERTIFY THAT TO THE BEST OF MY KNOWLEDGE THE PLAN SHOWN AND DESCRIBED HEREON IS TRUE AND CORRECT TO THE ACCURACY REQUIRED BY THE ADAMS COUNTY SUBDIVISION AND LAND DEVELOPMENT ORDINANCES.  
 28 APRIL '92  
 DATE \_\_\_\_\_

**REVIEWED:** ADAMS COUNTY PLANNING COMMISSION  
 DATE \_\_\_\_\_ DIRECTOR \_\_\_\_\_

**NOTARY STATEMENT**  
 ON THIS, THE 21<sup>st</sup> DAY OF March, 1992, BEFORE ME THE UNDERSIGNED OFFICERS PERSONALLY APPEARED John F. Folk (John F. Folk Vice President Operations) WHO BEING DULY SWORN ACCORDING TO LAW DEPOSES AND SAYS HE IS THE OWNER AND/OR EQUITABLE OWNER OF THE PROPERTY SHOWN HEREON AND THAT HE ACKNOWLEDGES THE SAME TO BE RECORDED AS SUCH ACCORDING TO LAW.  
 WITNESS MY HAND AND SEAL THE DAY AND DATE ABOVE WRITTEN. *Ray Louise Houser*  
 MY COMMISSION EXPIRES Nov. 9, 1992

**DEED REFERENCE**  
 RECORDED IN ADAMS COUNTY COURTHOUSE  
 IN DEED BOOK 400, PAGE 174.

**FINAL SUBDIVISION PLAN**  
 FOR  
 BROYHILL AND ASSOCIATES, INC.  
 OF  
 LOT NUMBERS E-21  
 TOWNSHIP OF OXFORD, TOWNSHIP OF CONEWAGO, COUNTY OF ADAMS  
 COMMONWEALTH OF PENNSYLVANIA  
 PLAN PREPARED BY  
 TRIMBLE SURVEYORS  
 LITITZ, PA.  
 (717)-626-0028  
 REVISED 19 MARCH 1992 10 JUNE 1992  
 28 APRIL 1992